

(1) SMR Code	(2) Federal Stock Number	(3) DESCRIPTION	(4) UNIT	(5) Qty	(6) 30-day DS maint	(7) 30-day GS maint	(8) 1-yr Depot	(9) Illustration	(10)	(a) allowance	(b) allowance	(c) allowance	(a) alw	(b) alw	(c) alw	(a) per equip	(b) per equip	(a) Figure No.	(b) Item No.
-----------------	-----------------------------	--------------------	-------------	------------	------------------------	------------------------	-------------------	---------------------	------	------------------	------------------	------------------	------------	------------	------------	------------------	------------------	-------------------	-----------------

Reference Number & Mfr. Code

Usable On Code

(a) (b) (c) (a) (b) (c) gcy

0703-TRANSMISSION CLUTCH AND CLUTCH CONTROLS-CONTINUED

P-F	2520-734-8769	HOUSING,CLUTCH: 7348769 (19207)	A	EA	1	*	*	*	*	*	*	2	5	46					2
P-O	5340-752-0976	PLUG,EXPANSION: LEVER SHAFT HOLE 7520976 (19207)	A	EA	1	*	*	*	*	*	*	6	10	46					3
P-F	2520-318-4310	GASKET: TRANSMISSION TO CLUTCH HOUSING (COMPONENT OF GASKET SET, FSN 2520-692-6183 8333623 (19207)	A	EA	1	*	*	*	*	*	*	10		46					4
P-O	4730-278-4216	ELBOW,PIPE: CLUTCH RELEASE SHAFT 7337759 (19207)	A	EA	2	*	*	*	*	*	*		10	46					5
P-O	4730-288-8497	CUP GREASE: CLUTCH RELEASE SHAFT 112465 (12204)	A	EA	2	*	*	*	*	*	*	4	10	46					6
P-O	2520-752-0957	GASKET: INSPECTION HOLE COVER (COMPONENT OF GASKET SET, FSN 2520-692-6183 7520957 (19207)	A	EA	1	*	*	*	*	*	*	15		46					7
P-O	2520-752-0956	COVER PLATE,ACCESS: INSPECTION HOLE 7520956 (19207)	A	EA	1	*	*	*	*	*	*	2	5	46					8
P-O	5306-637-4914	BOLT,MACHINE: COVER PLATE MS35297-34 (96906)	A	EA	6	*	*	*	*	*	*	6	10	46					9
P-O	5310-407-9566	WASHER,LOCK: COVER PLATE MS35338-45 (96906)	A	EA	6	*	*	*	*	*	*	6	10	46					10
P-O	5330-286-6815	SEAL,PLAIN ENCASED: LEVER SHAFT HOLE 500021 (21450)	A	EA	1	*	*	*	*	*	*	10	20	46					11
P-F	5310-010-3030	NUT,PLAIN,HEXAGON: TRANSMISSION CLUTCH HOUSING MS35690-1024 (96906)	A	EA	7	*	*	*	*	*	*	6	10	46					12
P-F	5310-010-3325	WASHER,LOCK: TRANSMISSION CLUTCH HOUSING MS35338-12 (96906)	A	EA	7	*	*	*	*	*	*	6	10	46					13
P-F	5307-207-2642	STUD,PLAIN: CLUTCH, HOUSING 8333625 (19207)	A	EA	7	*	*	*	*	*	*	6	10	46					14

0704-TRANSMISSION TOP COVER ASSEMBLY

P-O	5355-350-2457	KNOB: GEAR SHIFT HAND LEVER A167632 (19207)	A	EA	1	*	*	*	*	*	*	4	10	47					1
P-F	2520-040-2243	LEVER: GEAR SHIFTER 7376092 (19207)	A	EA	1	*	*	*	*	*	*	3	5	47					2
P-F	2520-737-6173	BOOT,DUST AND MOISTURE: GEAR SHIFT LEVER 7376173 (19207)	A	EA	1	*	*	*	*	*	*	6	10	47					3

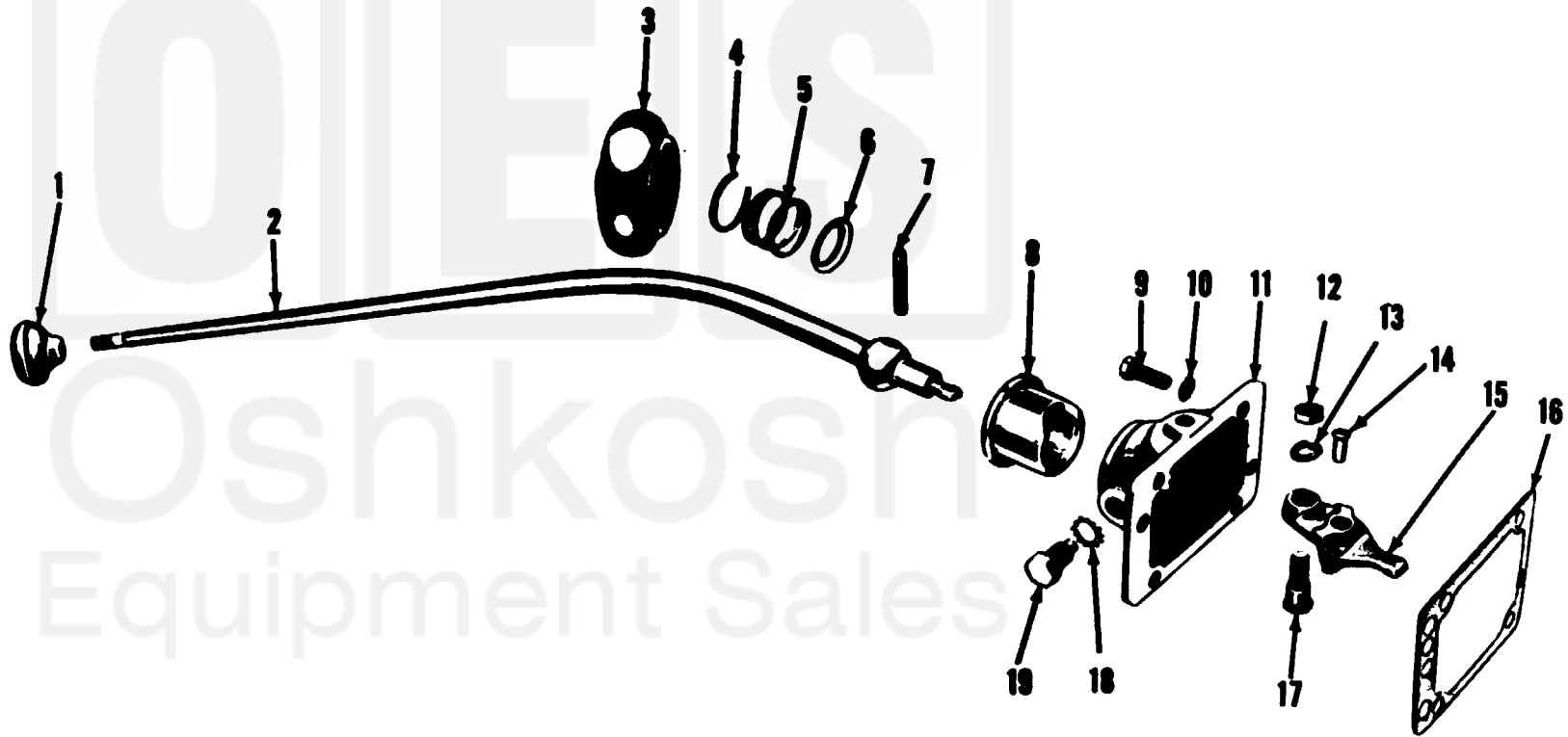

AT 47187

Figure 47. Transmission shifter housing cover and lever.